

AVALON 244 TWO STOREY



AREAS

GF Living	82.28 m ²
Garage	37.73 m ²
Porch	4.77 m ²
Patio	8.22 m ²
1F Living	111.60 m ²
TOTAL	244.61 m²

SIZE

Ground Floor

Length	18.24 m
Width	8.30 m

First Floor

Length	17.53 m
Width	6.78 m



Ground Floor

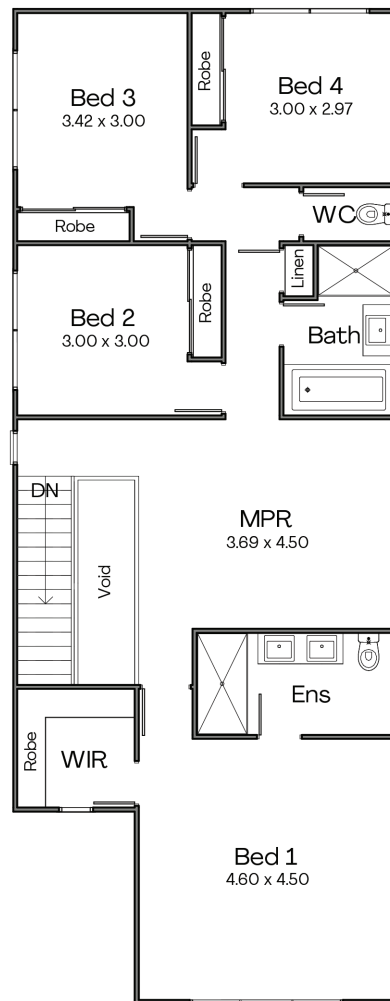

First Floor

For more information contact **1300 307 004** or visit coastlifelifehomes.com.au